

Creative, enthusiastic and want to make great projects happen?

Landscape year out placement

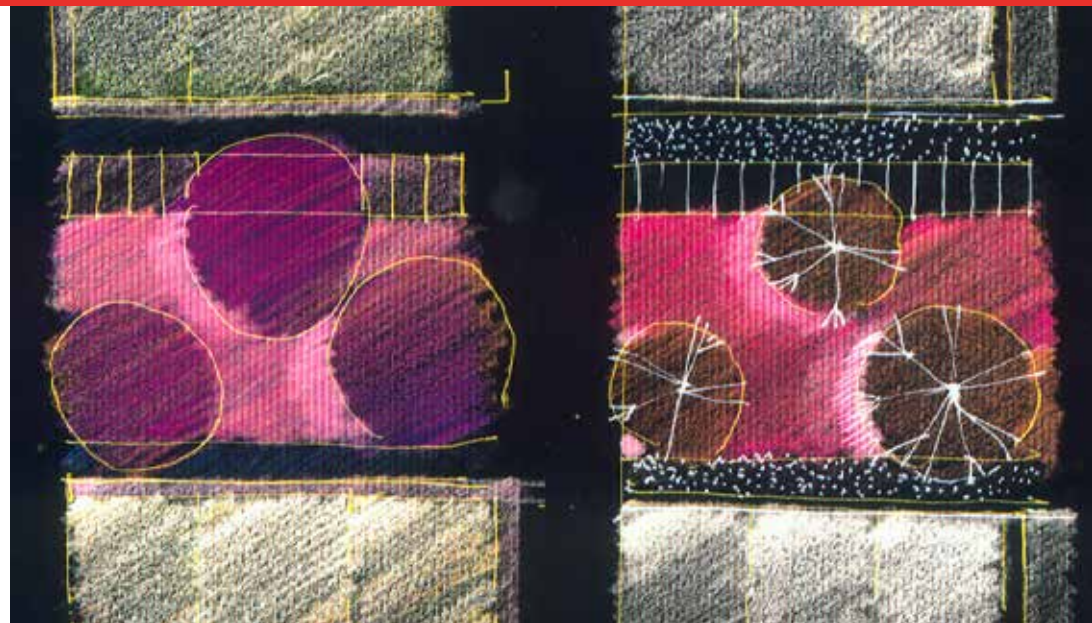

We are an award winning multi-disciplinary practice dedicated to creating successful environments. We operate throughout the UK from offices in Bournemouth and London. We specialise in town planning, urban design, environmental consultancy, landscape architecture, master planning, architecture and graphic design.

We require a landscape year out placement to assist and support our landscape architectural team in our Bournemouth office, working on hard and soft landscape projects for both public and private sector clients. You will be involved in an exciting range of projects that include large housing developments and master plans, urban and countryside parks, industry and R&D projects. We offer a competitive salary, benefits, excellent working conditions, CPD opportunities and a dynamic office environment.

- To have completed or be currently undertaking a BA(Hons) course in landscape architecture
- Strong design and drawing skills
- Strong writing and communication skills
- Self motivated, enthusiastic, proactive
- Good communication skills
- Experience of the following software would be desirable;
 - Vectorworks/AutoCAD
 - Adobe InDesign
 - Adobe Illustrator
 - Sketchup

Are you interested in us?

Please send your CV and 4 x A3 examples of your work to: careers@torltd.co.uk **Deadline: 29 May 2015**

TELEPHONE
020 3664 6755

www.torltd.co.uk



TERENCE
O'ROURKE